

1 PLANTA BAIXA DETALHES COZINHA
1 : 25

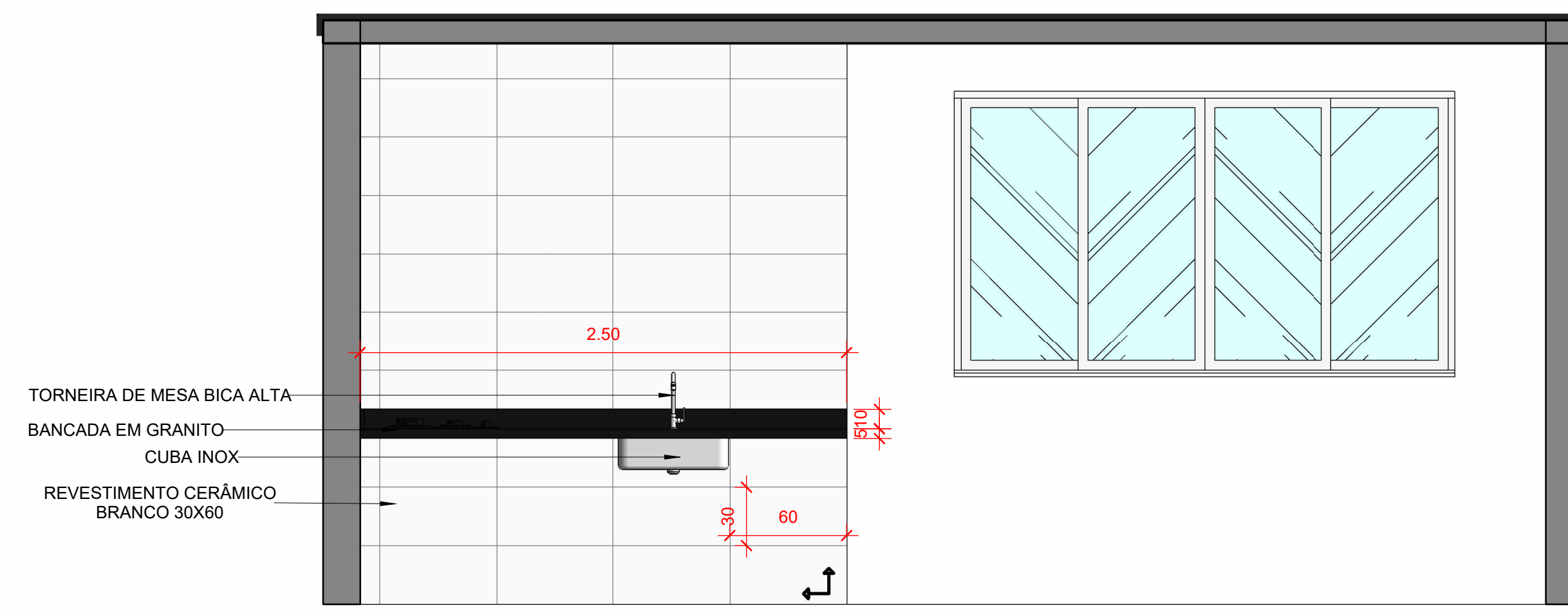

2 COZINHA - V1
1 : 25

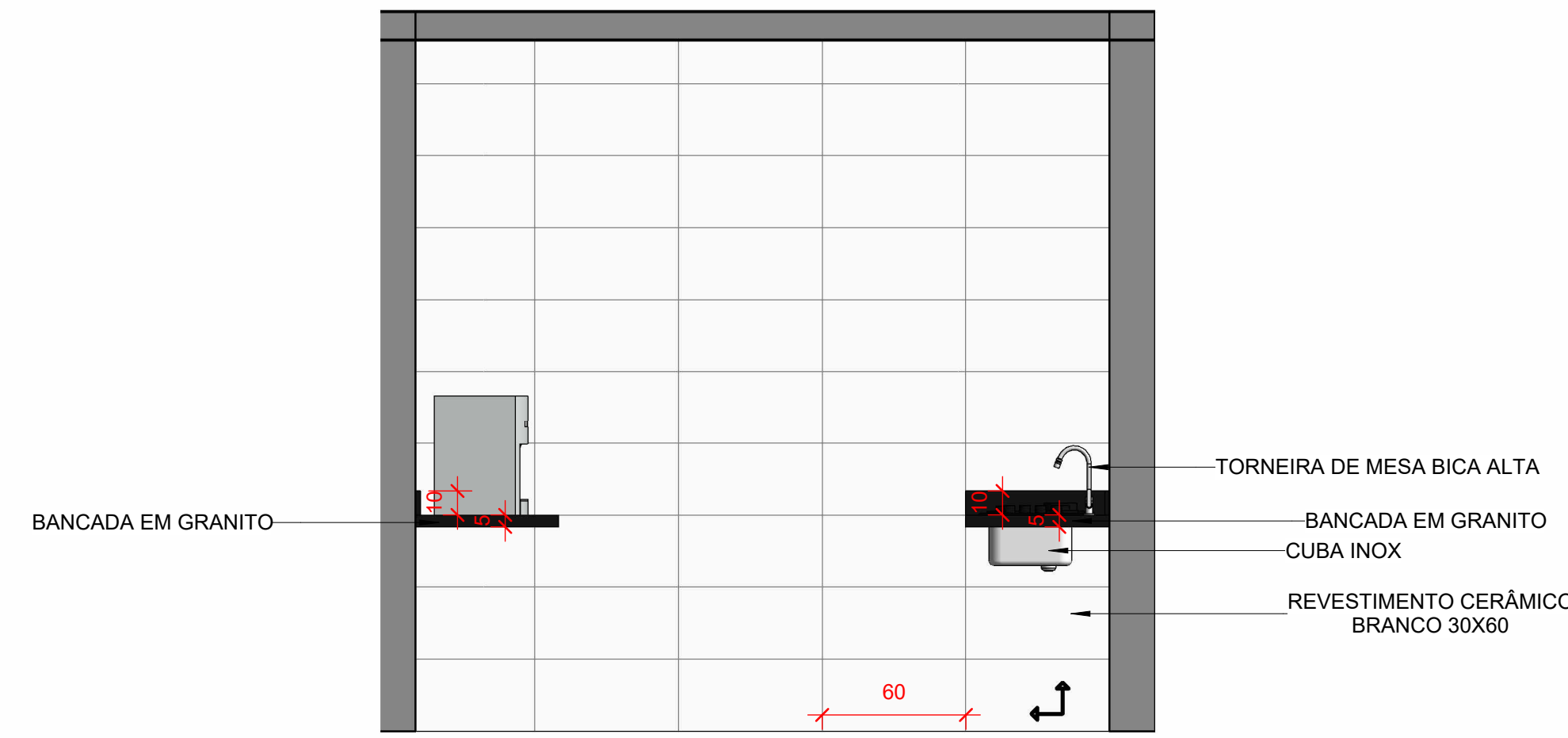

3 COZINHA - V2
1 : 25

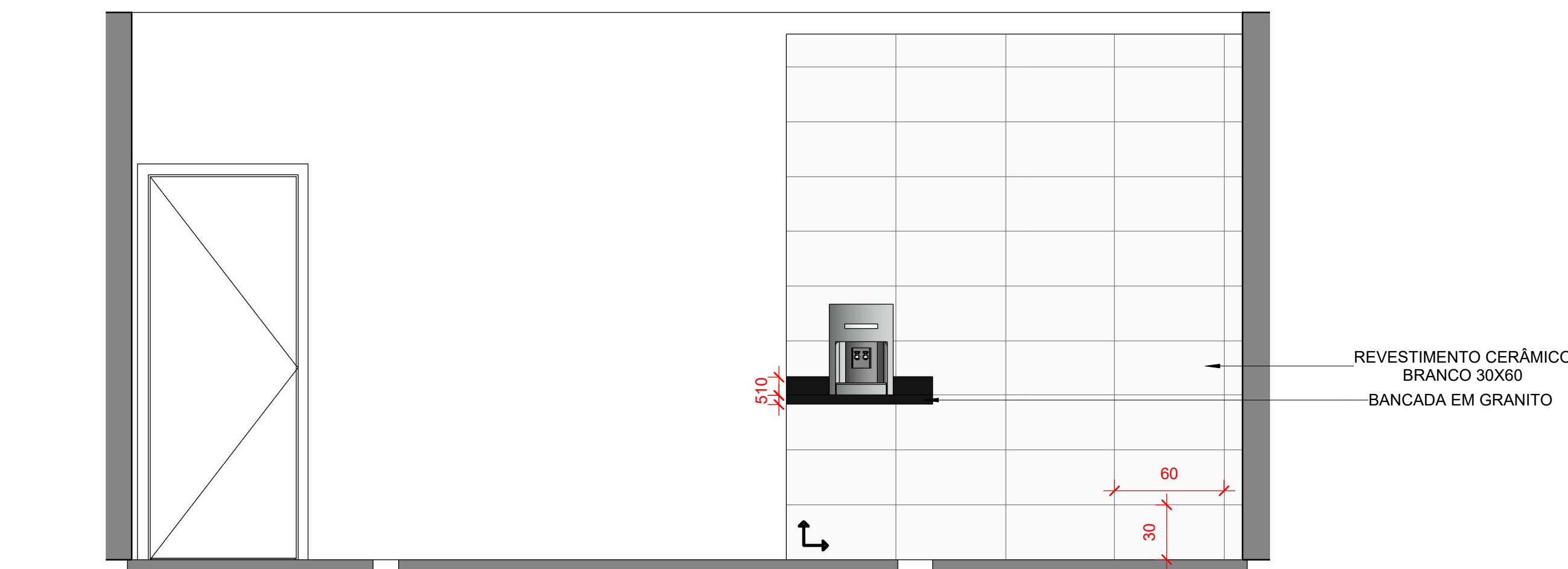

4 COZINHA - V3
1 : 25

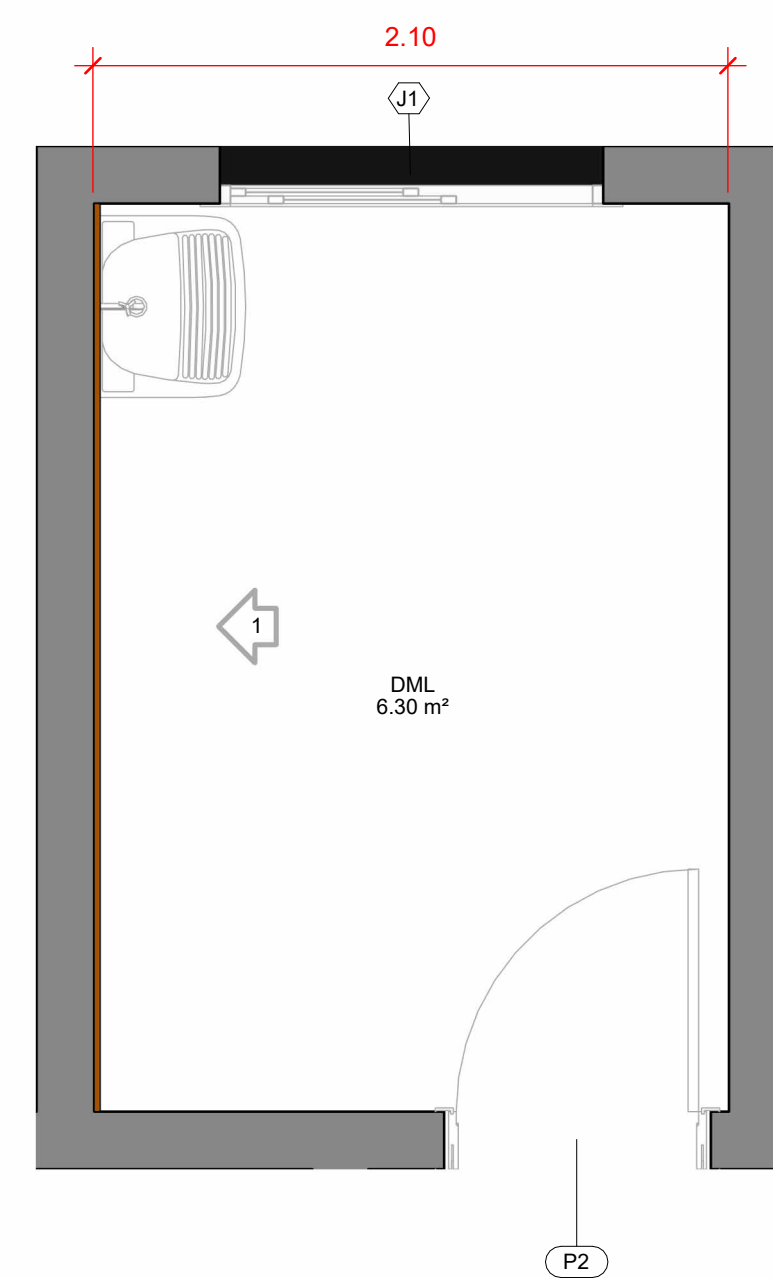

6 PLANTA BAIXA DETALHES DML
1 : 25

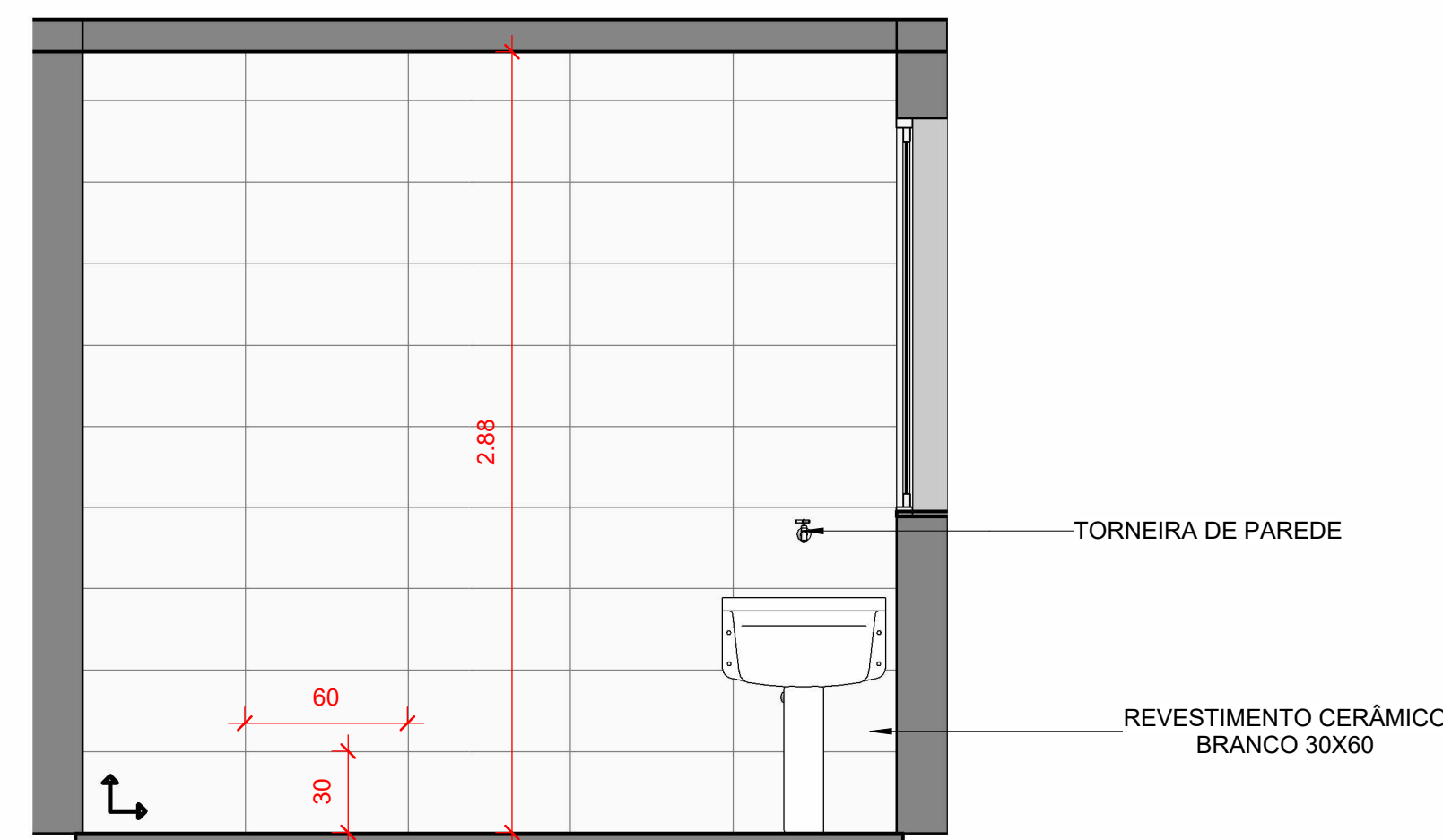

5 DML - V1
1 : 25

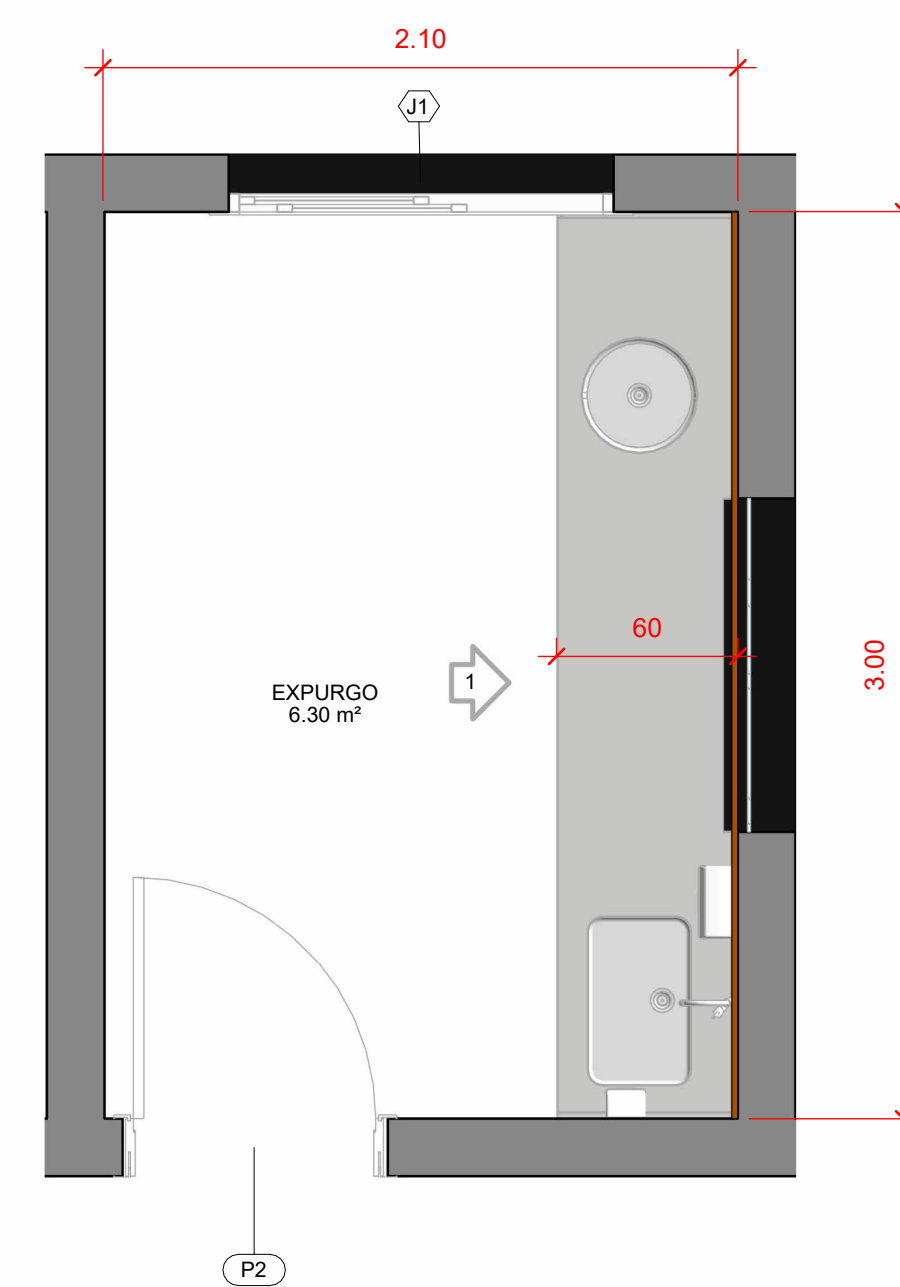

8 EXPURGO - V1
1 : 25

7 PLANTA BAIXA DETALHES EXPURGO
1 : 25

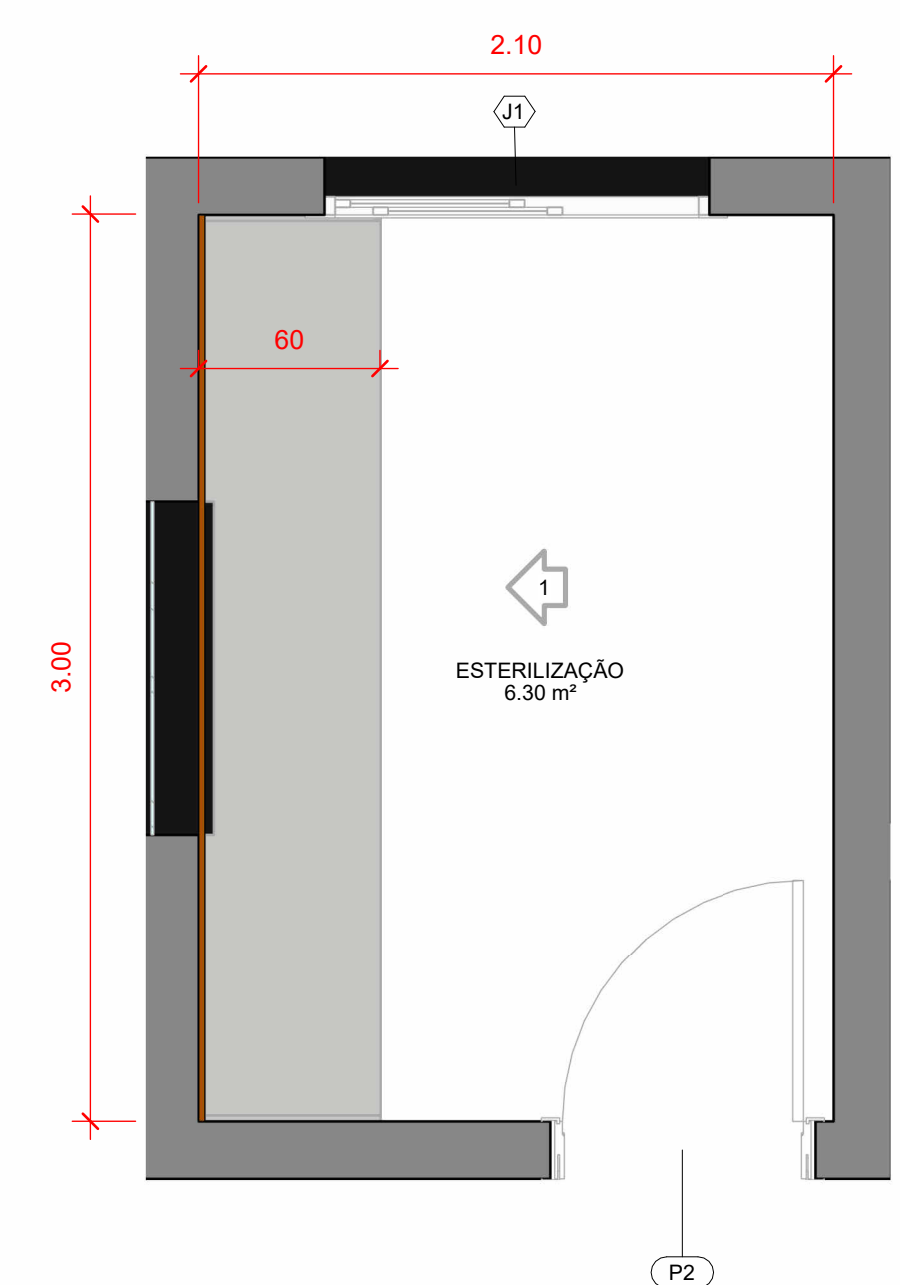
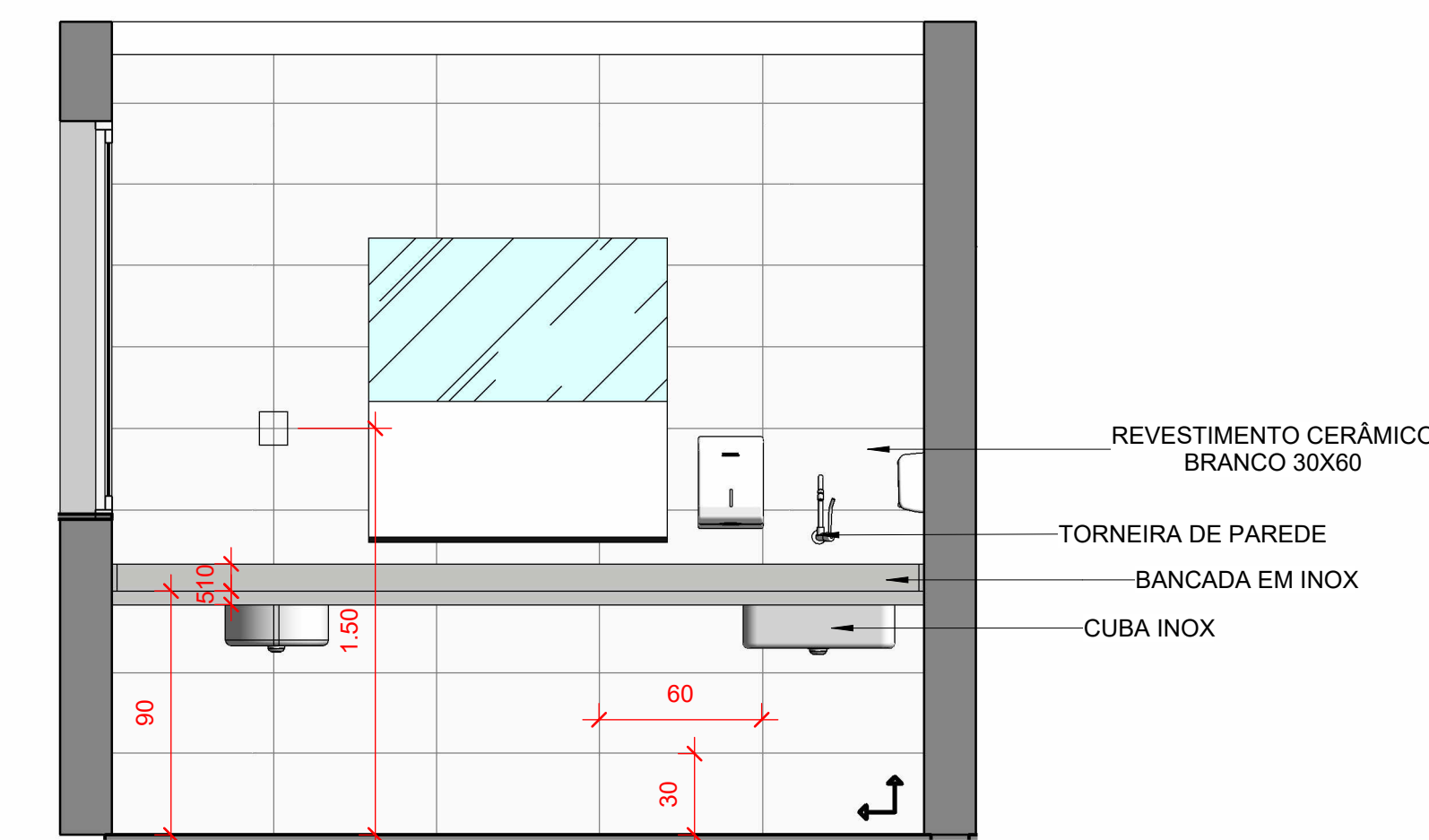

9 PLANTA BAIXA DETALHES ESTERILIZAÇÃO
1 : 25

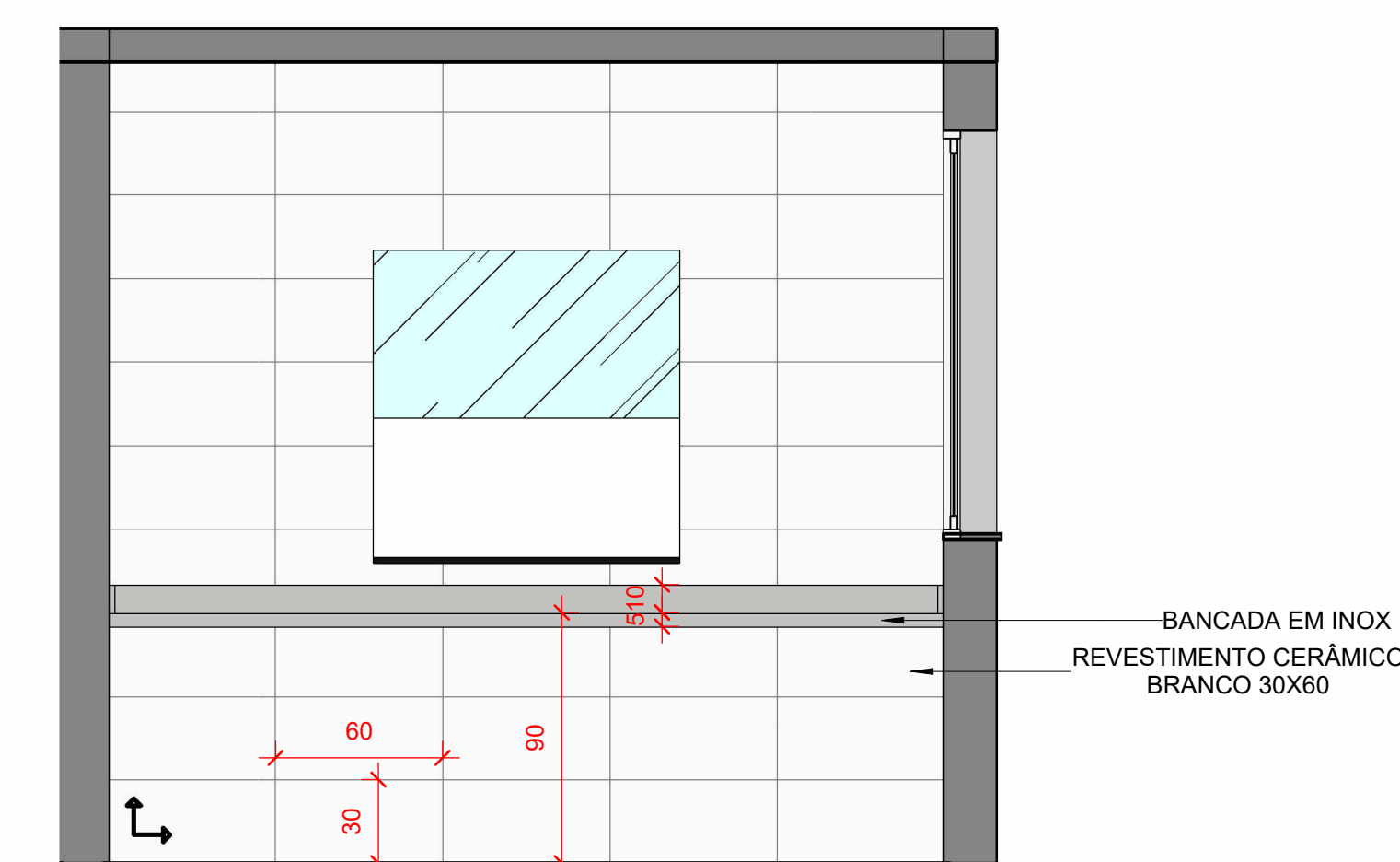

10 ESTERILIZAÇÃO - V1
1 : 25

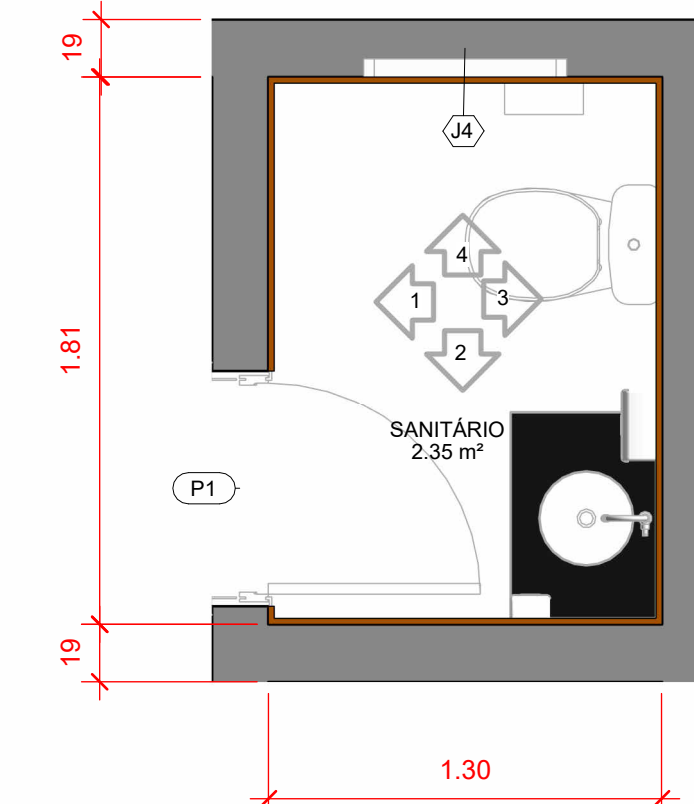

11 PLANTA BAIXA DETALHE BWC ADM.
1 : 25

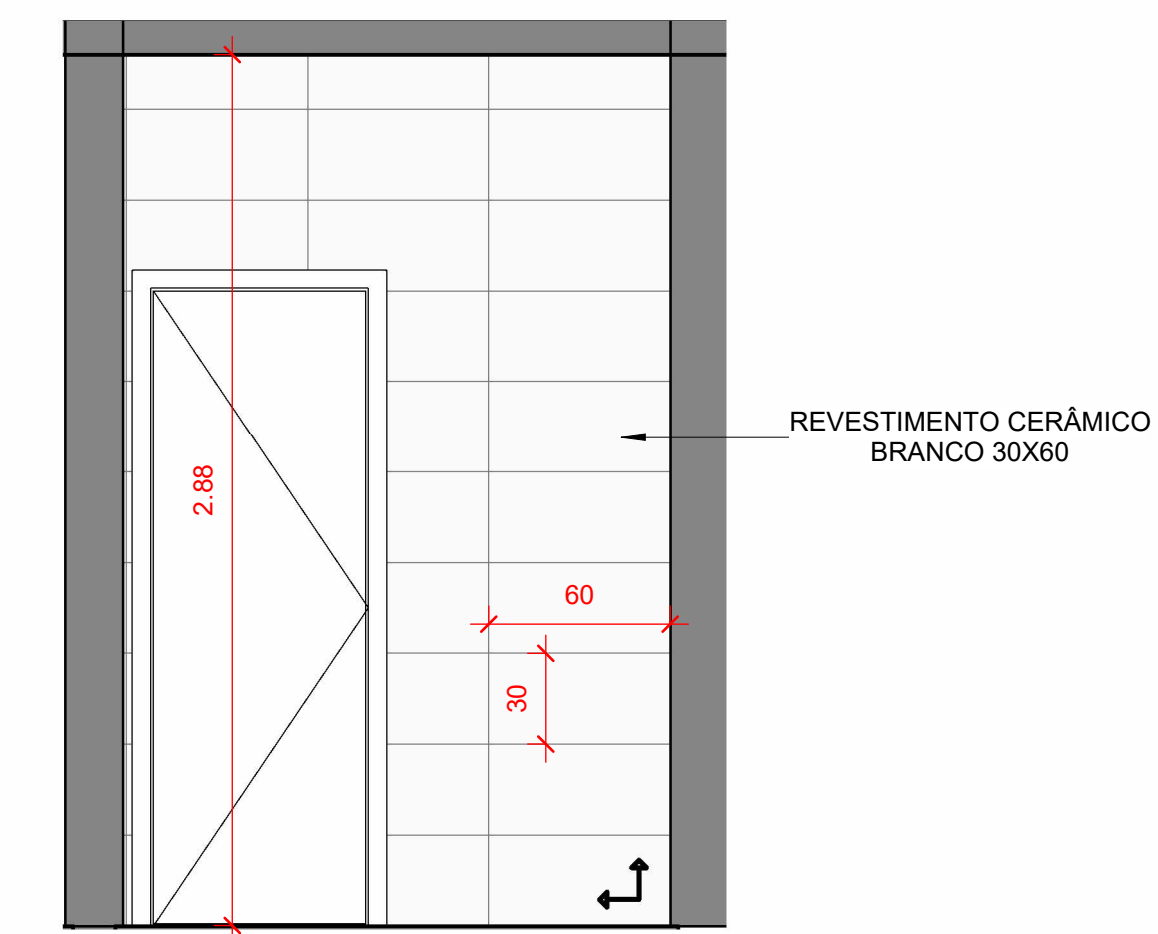

12 BWC ADM. - VISTA 1
1 : 25

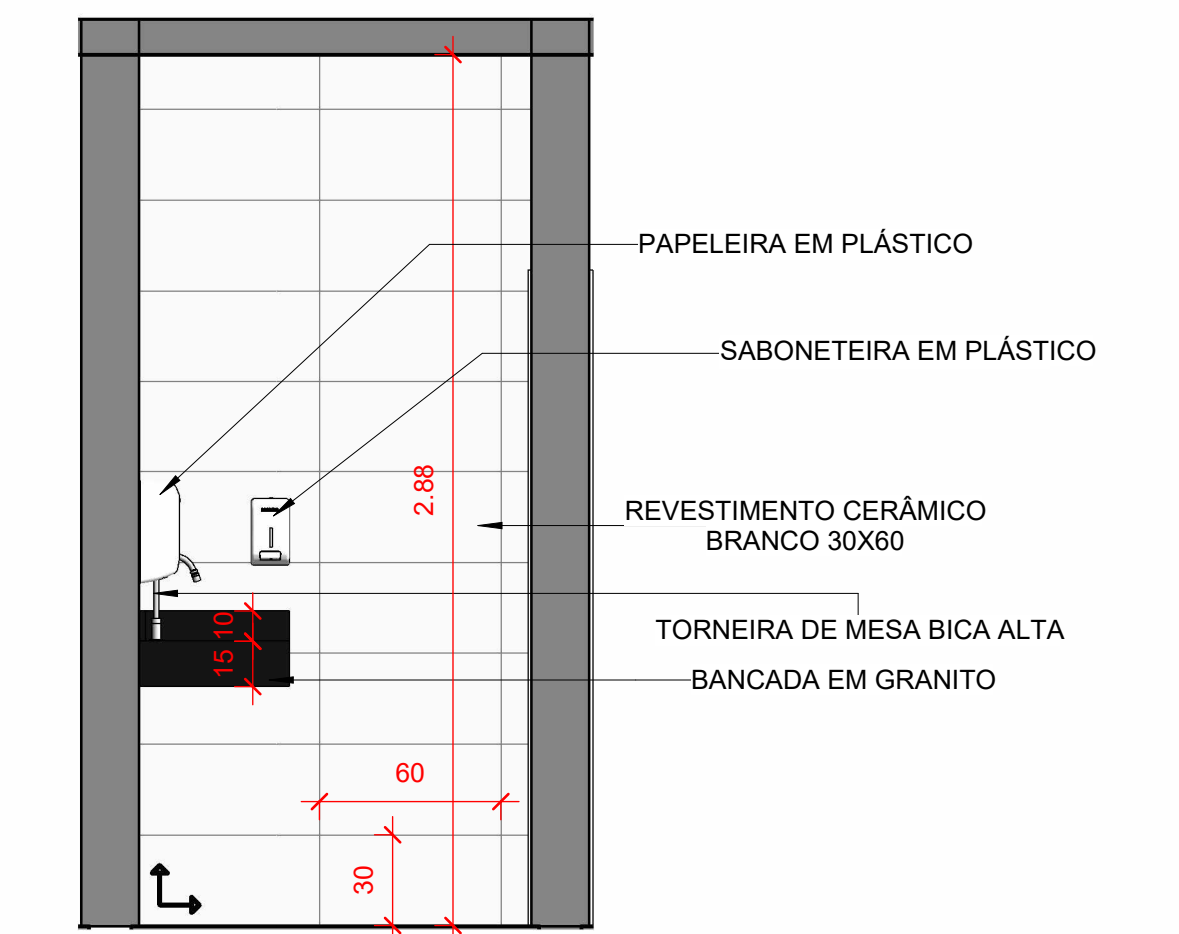

13 BWC ADM. - VISTA 2
1 : 25

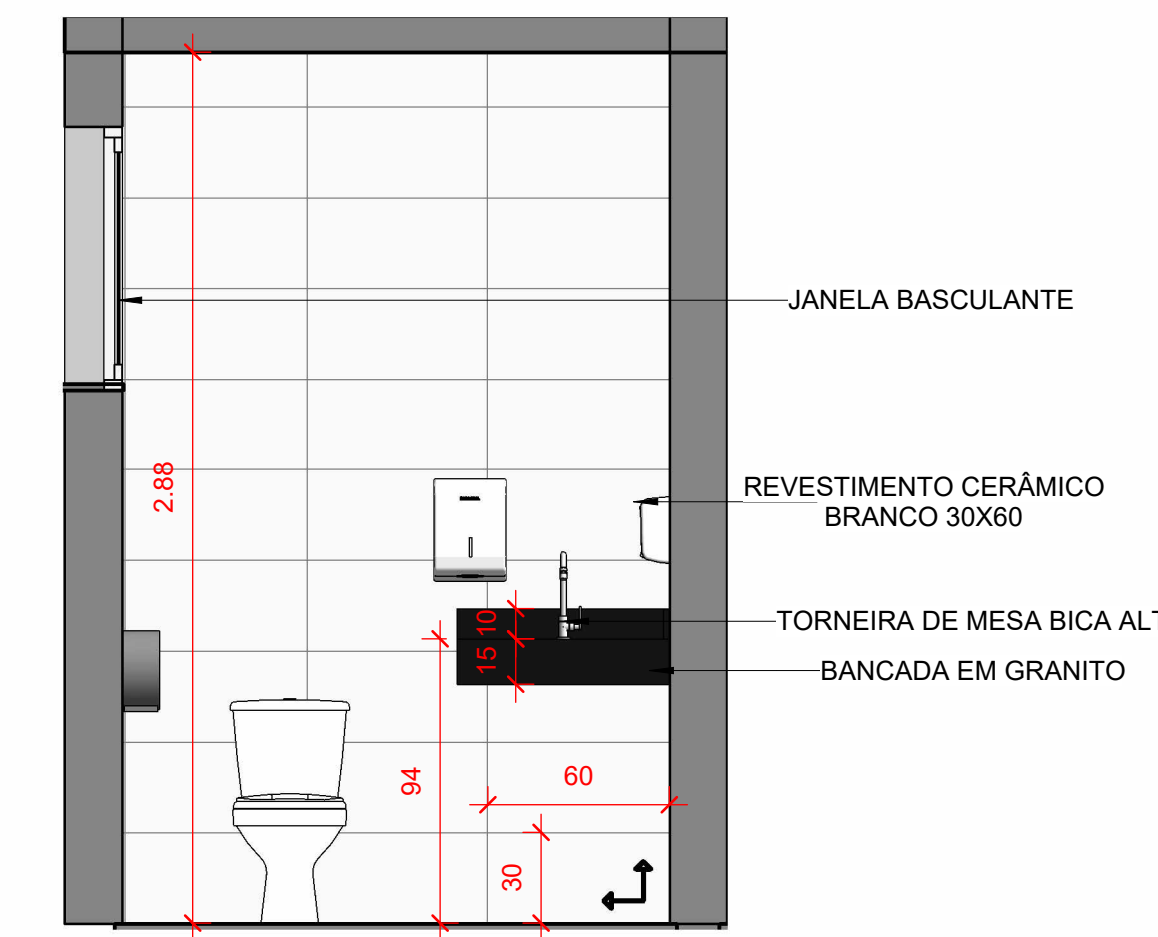

14 BWC ADM. - VISTA 3
1 : 25

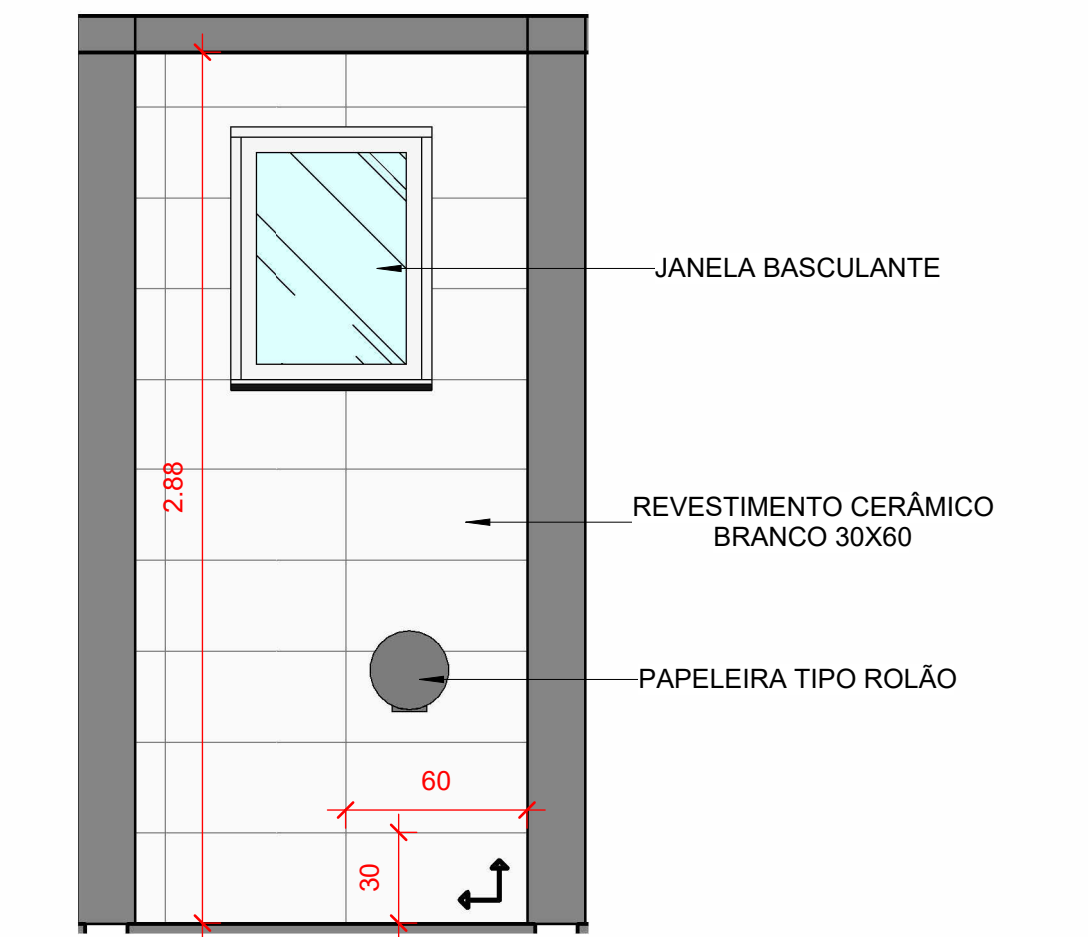

15 BWC ADM. - VISTA 4
1 : 25

ARQUITETÔNICO

OBRA:
Unidade Básica de Saúde Rachadel
PROPRIETÁRIO:
Município de Antônio Carlos
ENDEREÇO:
Rua Nilton Clegerio Schmitz, s/n, bairro Rachadel - Antônio Carlos/SC
Município de Antônio Carlos

Desenhada por:
Gian Mizunoro - CREA/SC 159.024-4
Engenheiro Civil

ARQ 7/9

Escala:
Conforme Indicado

